



## OFFICE DESIGN IDEAS BOOK FOR:

- OFFICE SUITES
- CONFERENCE ROOM
- WORKSTATIONS
- LOUNGE AREA
- PANTRY/CAFETERIA
- SEATING: TASK, CONFERENCE & GUEST

## EMRNICPRS

3,600 SQ. FT.

LASALLE, QC, CANADA



**cubicles.com**

we're so much more than cubicles

☎ 888-442-8242

# PROPOSED LAYOUT

## OPEN AREA

[12] 6'X6'x34" /54"H L-SHAPE STATIONS

[1] MOBILE PEDESTAL + CUSHION /EA

## OFFICE #1 & #2

[2] 2'-6"X5' STRAIGHT DESK

[1] MOBILE BOX/BOX/FILE PEDESTAL

## CONFERENCE ROOM

[1] 4'Dx10'W POWERED TABLE

## LOUNGE AREA

[2] LOUNGE CHAIRS

[1] 3 SEATER SOFA

[1] COFFEE TABLE

## SEATING

[2] MANAGER CHAIRS

[13] TASK CHAIRS FOR CUBICLES & RECEPTION

[4] GUEST CHAIRS

[10] CONFERENCE CHAIRS

[8] PANTRY CHAIRS

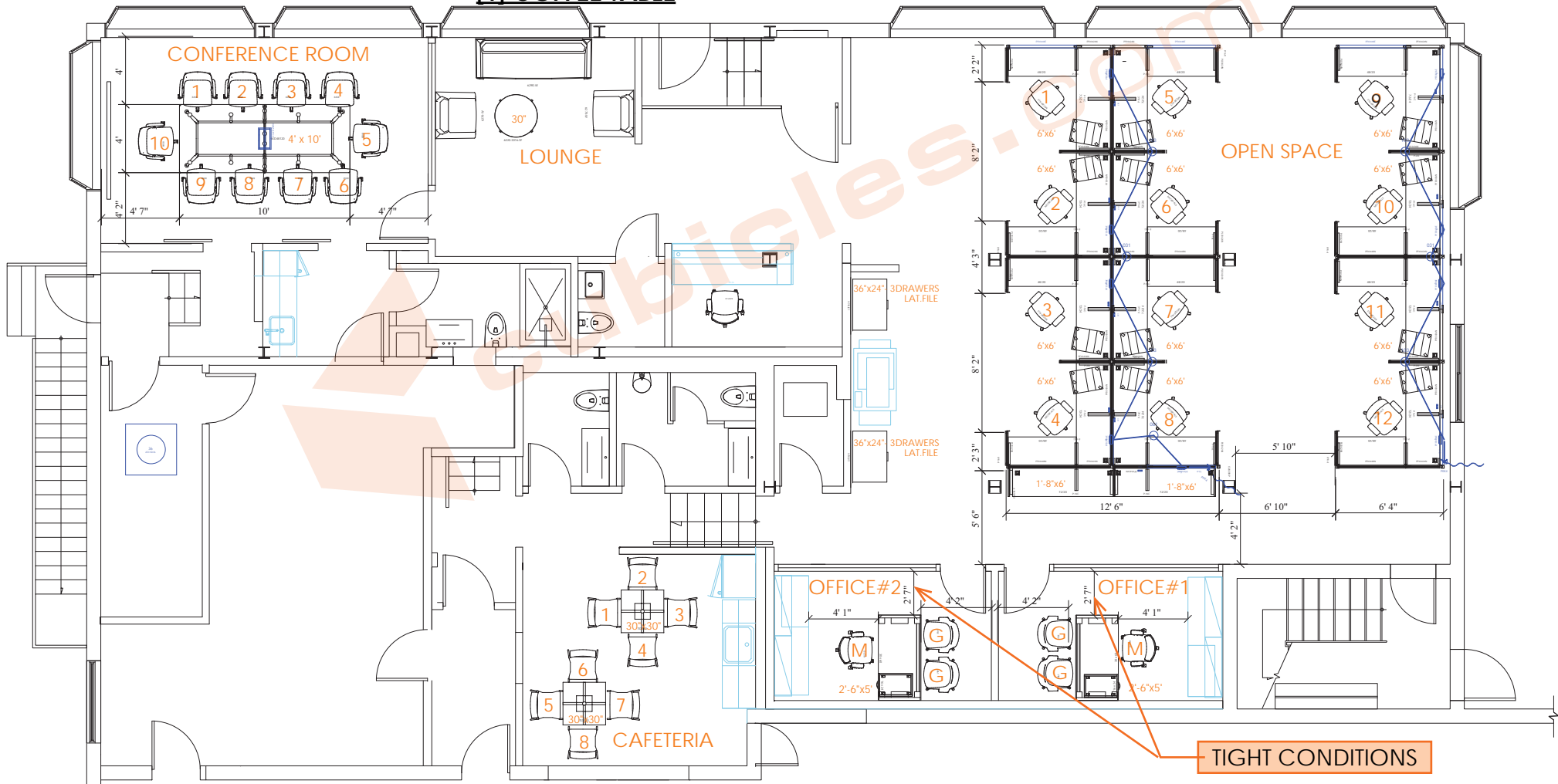

# 3D OVERALL PROPOSED LAYOUT

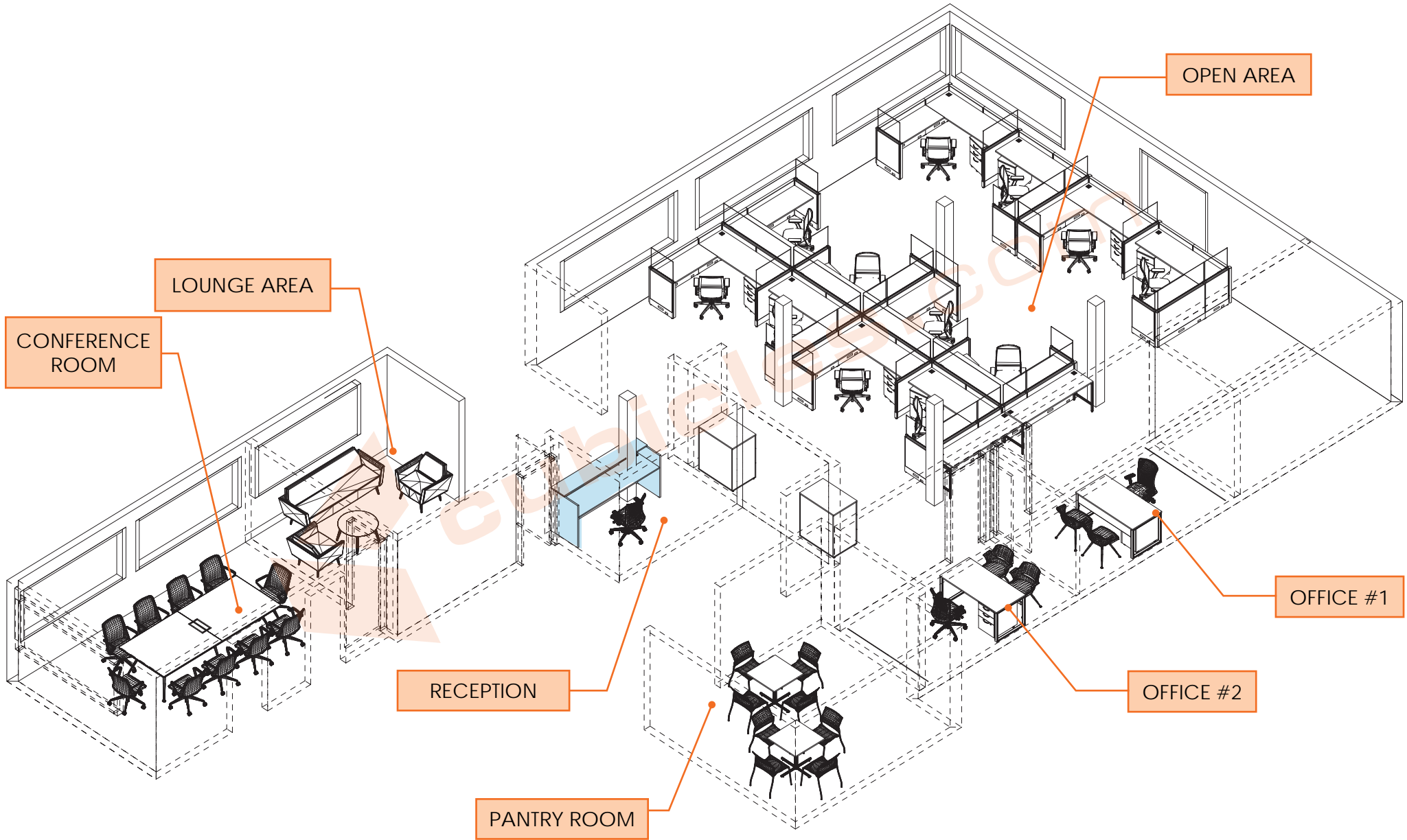

# OPEN AREA YAT POWERED SYSTEM

## [12] 6'X6'x54"H [34"H PANELS+20"H ACRYLIC SCREENS] L-SHAPE POWERED STATIONS

### ACCESSORIES

- [1] MOBILE PEDESTAL + CUSHION /EA.
- [1] duplex receptacle & [1] Data plate /EA.

## [1] 1'-8"X12'x54"H PRINT STATION

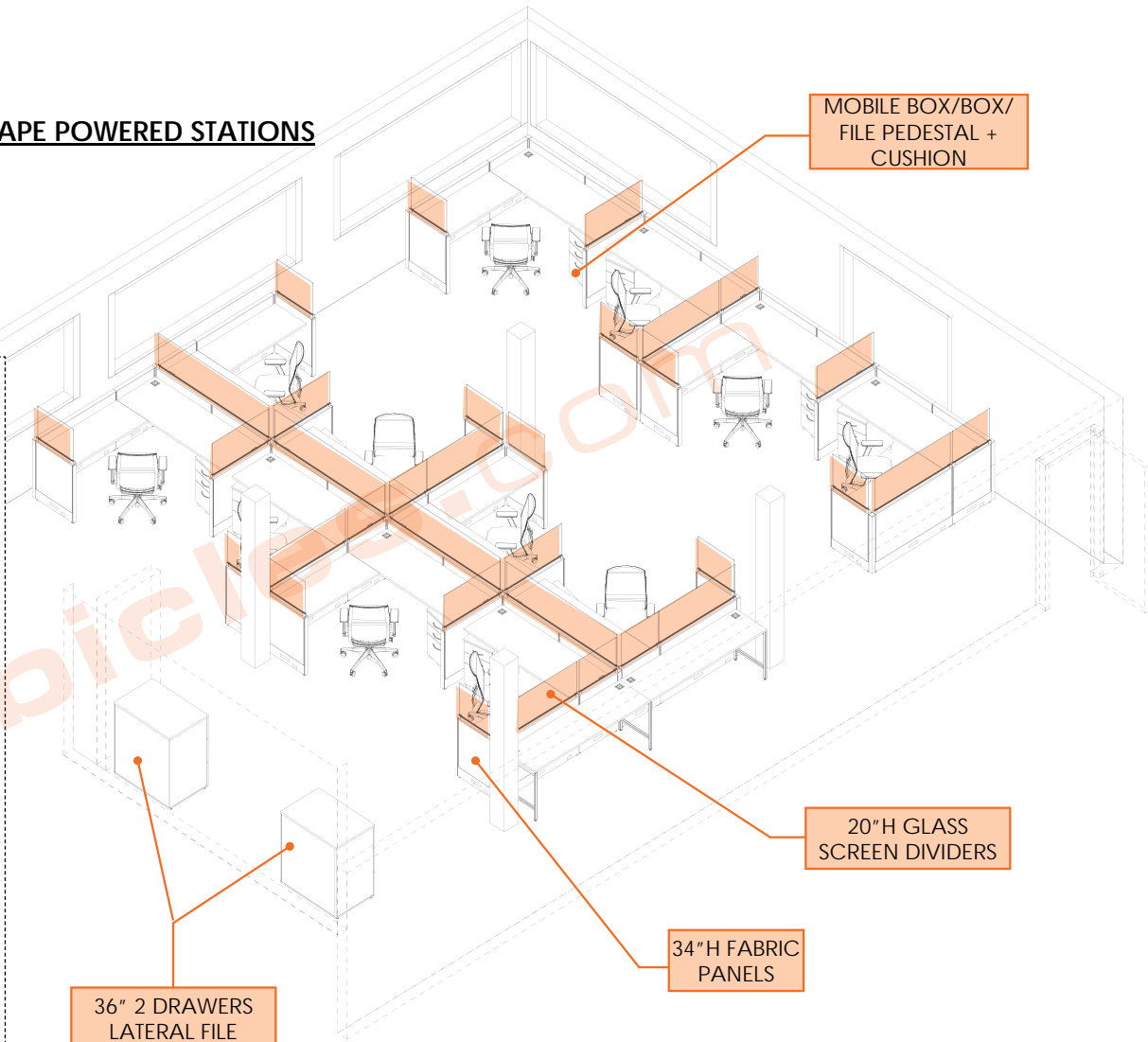
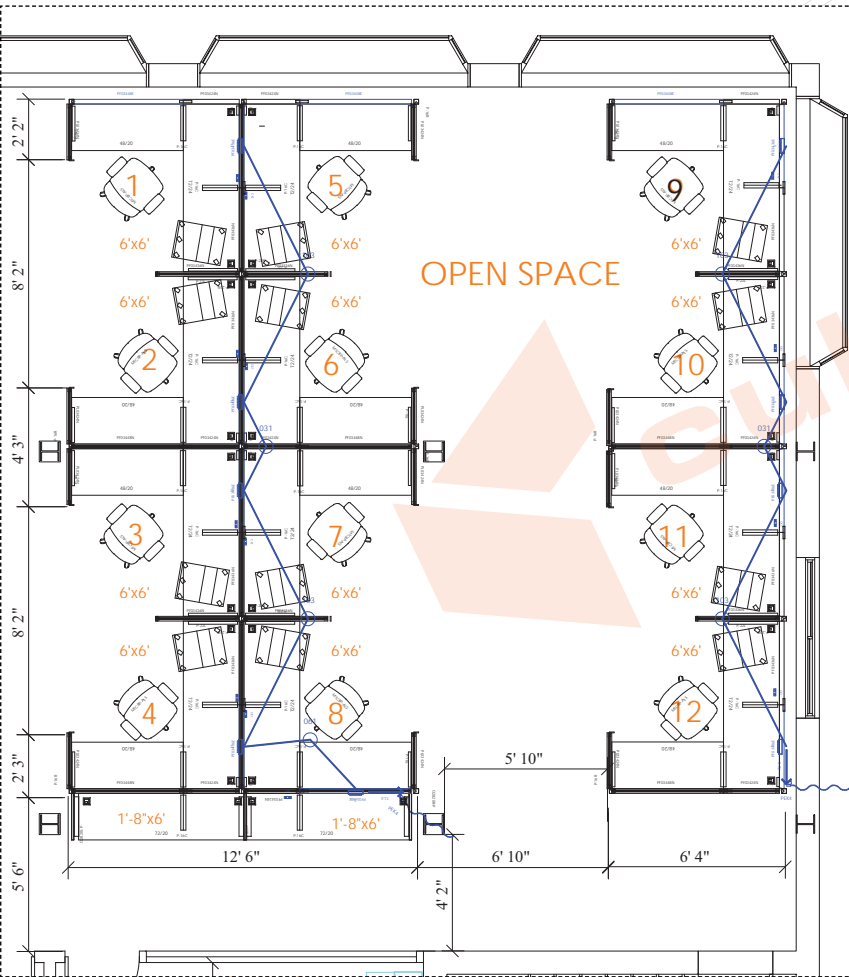

LAMINATE: TBD | PANEL FABRIC: GRADE 2: TBD | HANDLES: TBD  
| METAL FINISH: TBD | FROSTED ACRYLIC

# YAT POWERED SYSTEM



## OFFICES #1 & #2

YAT

[2] 2'-6" x 5' STRAIGHT DESK

ACCESSORIES:

[1] MOBILE BOX/BOX/FILE PEDESTAL  
W/ ACRYLIC MODESTY PANEL

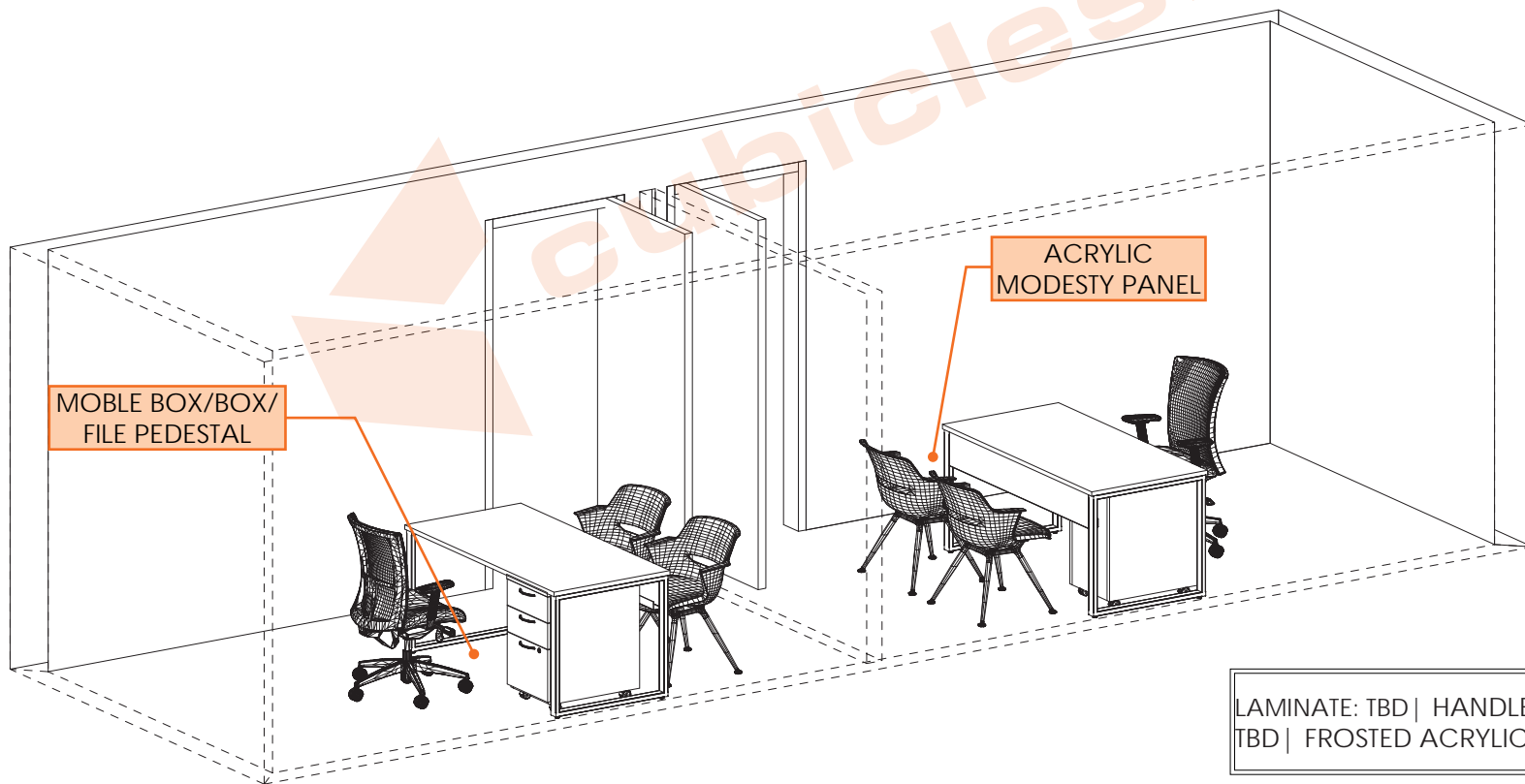
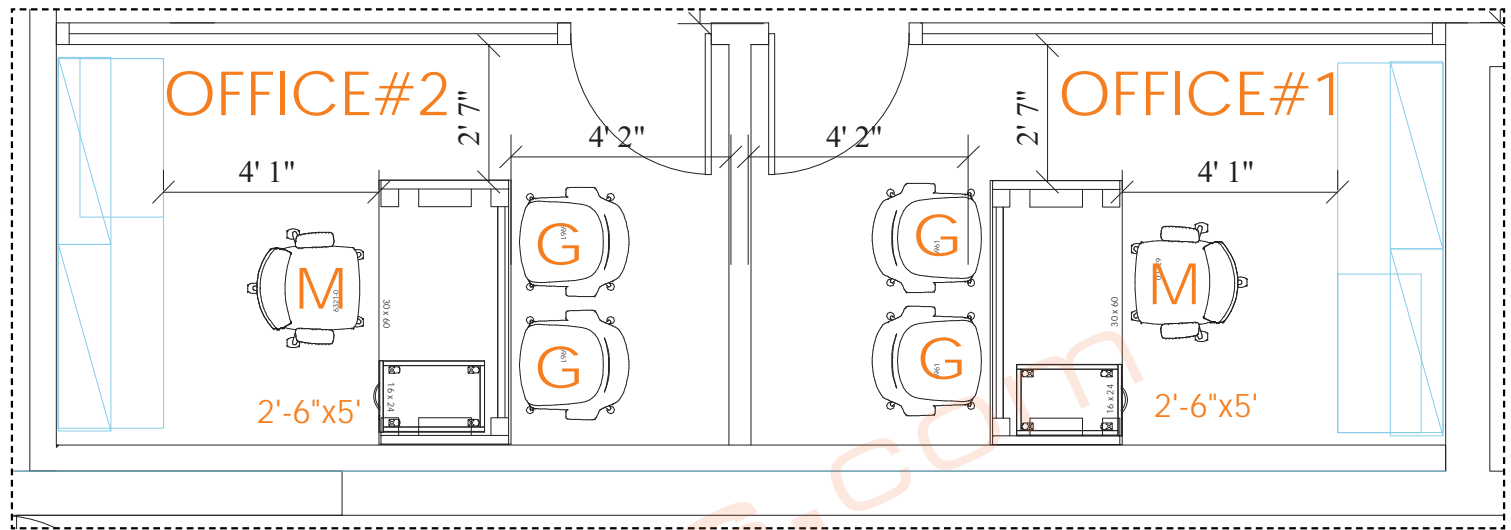

LAMINATE: TBD | HANDLES: TBD | O-LEGS PAINT:  
TBD | FROSTED ACRYLIC MODESTY PANEL

YAT



# CONFERENCE ROOM - OPTION 1

## YAT TABLE

### [1] 4'Dx10'W RECTANGULAR POWERED TABLE

#### ACCESSORIES:

Two power boxes, dual USB, & one open slot for RS45/RJ11/  
HDMI/video.

1 slot open for HDMI, RJ-11, RJ-45

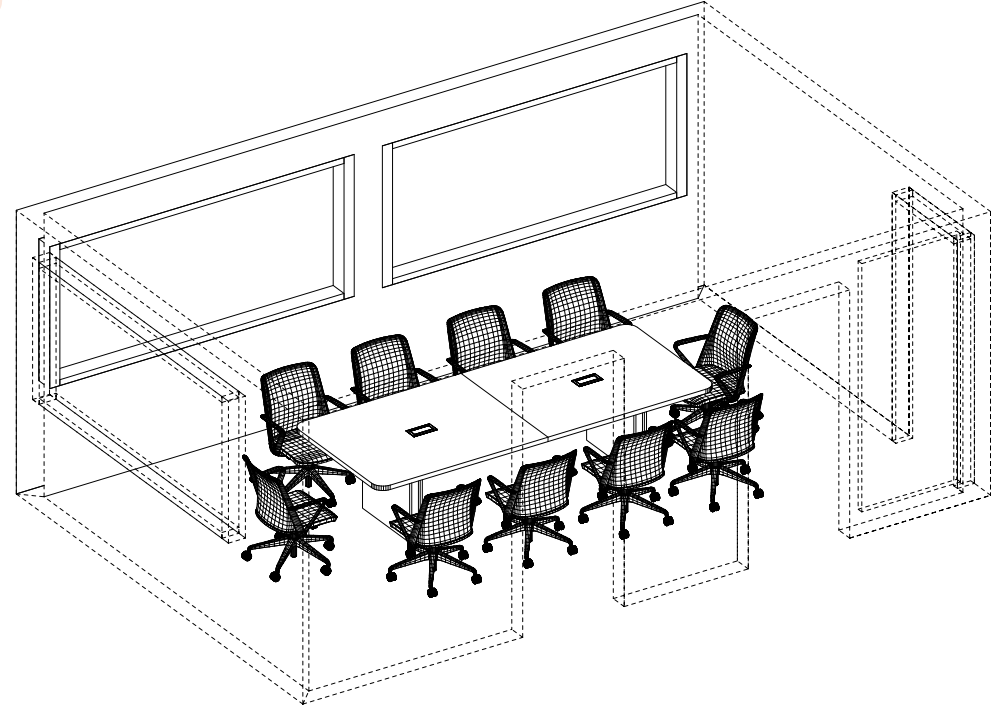
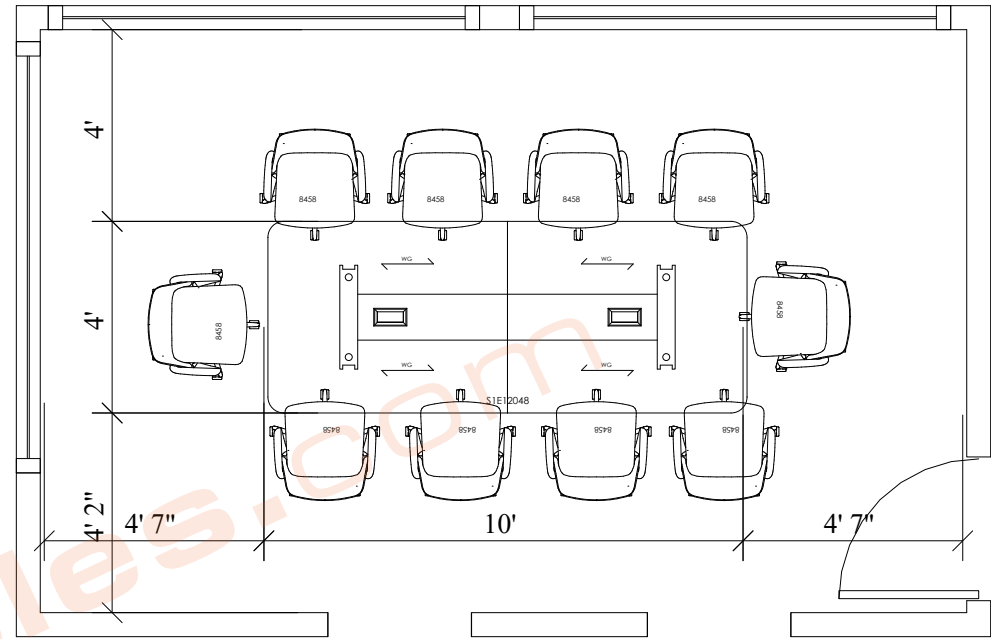



## CONFERENCE ROOM - OPTION 2

### EIN A-FRAME TABLE

#### [1] 4'Dx10'W RECTANGULAR POWERED TABLE

ACCESSORIES:

[1] POWER BOX dual USB, & one open slot for RS45/RJ11/HDMI/video.

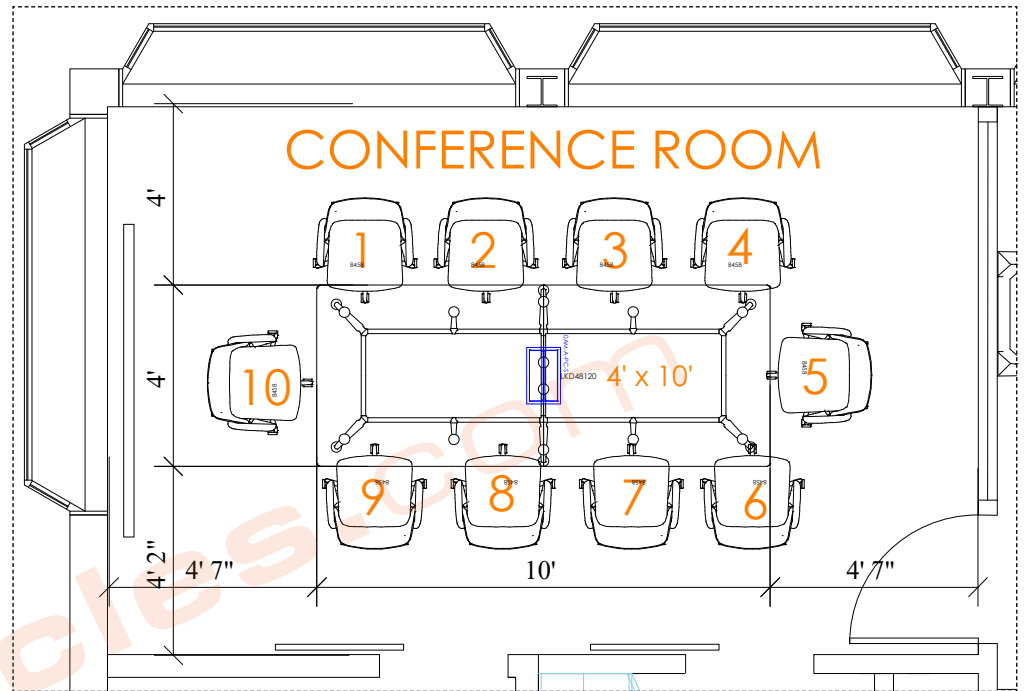

## LOUNGE AREA - OPTION 1

### CNE Lounge Chair

**QTY:2**

Dimensions: 23.25" W x 28.5" D x 31.75" H  
GRADE 1 FABRIC: TBD | WOOD COLOR: TBD



### CNE SEAT

**QTY:1**

Dimensions: 44.25" W x 28.75" D x 31.75" H  
GRADE 1 FABRIC: TBD | WOOD COLOR: TBD



### CNE TABLE - SOLID TOP

**QTY:1**

Dimensions: 29"D x 20"H  
TOP LAMINATE: TBD | WOOD COLOR: TBD



## **LOUNGE AREA - OPTION 2**

### **CNE Lounge Chair, Fixed Wood Legs**

**QTY:2**

Dimensions: 32"W x 29"D x 29.5" H

GRADE 1 FABRIC: TBD | WOOD COLOR: TBD



### **CNE Sofa, Fixed Wood Legs**

**QTY:1**

Dimensions: 58"W x 29"D x 29.5" H

GRADE 1 FABRIC: TBD | WOOD COLOR: TBD



### **CNE Occasional Table 30"D x 16"H, Solid Surface Top**

**QTY:1**

Dimensions: 30"D x 16"H

TOP LAMINATE: TBD | WOOD COLOR: TBD



## **PANTRY ROOM**

### **YAT Table**

**QTY:2**

Dimensions: 30"x30"

FRAME FINISH: TBD | LAMINATE: TBD

**[PANTRY ROOM]**



### **CNE CHAIR - OPTION 1**

**QTY:8**

Dimensions: 19.75" W x 21" D x 31.75" H

FRAME FINISH: TBD | COLOR: TBD

Poly Shell, 4-Leg Base

**[PANTRY ROOM]**



### **IGL High Back Chair with Cushion - OPTION 2**

**QTY**

Dimensions: 20-1/4"W x 21-1/2"D x 31"H

FRAME FINISH: TBD | WOOD: TBD |

CUSHION: TBD

**[PANTRY ROOM]**



## TASK SEATING

### YAT TASK CHAIR

**QTY:13**

Dimensions: W25.5 x D24 x H41.5 IN.  
GRADE 1 FABRIC: TBD | MESH BACK: TBD | FRAME:  
COOL GREY/BLACK | BASE: BLACK/CHROME/  
COOL GREY  
[CUBICLE AREA & RECEPTION DESK]



## CONFERENCE SEATING

### YAT CONFERENCE CHAIR- FIXED ARMS

**QTY:10**

Dimensions: W25.5 x D24 x H41.5 IN.  
GRADE 1 FABRIC: TBD | MESH BACK: TBD | FRAME:  
COOL GREY/BLACK | BASE: BLACK/CHROME/COOL GREY  
[CONFERENCE ROOM]



## **GUEST SEATING**

### **OPTION 1 - CNE Guest Chair Wood Shell with Upholstered Seat Pad, 4-Leg Base**

**QTY:4**

Dimensions: 21.75" W x 21.5" D x 31" H  
GRADE 1 FABRIC: TBD | FRAME FINISH: TBD  
**[OFFICE#1&2]**



### **OPTION 2 - CNE Guest Chair, Fully Upholstered, Open Back, Glides**

**QTY:4**

Dimensions: 24" W x 25" D x 32" H  
GRADE 1 FABRIC: TBD |  
FRAME FINISH: TBD  
**[OFFICE#1&2]**



**CUBICLES.COM** is a nationwide leader in the world of office furniture and furniture services. We've spent the last 20+ years building and maintaining a vast network of manufacturers, designers, contractors and facilities allowing us to cater to the commercial office, the home office, and everything in between.

### CONTRACT OFFICE FURNISHINGS

Our full-service agency provides a dedicated hands-on team of professional designers, specifiers and project managers to deliver your commercial office project from a conceptual dream to a "ready to move in" reality. We are committed to providing every client with quality products, fair pricing, and efficient service.

### PRODUCTS INCLUDE:

Cubicles \* Desks \* Tables \* Reception \* Conference \* Seating  
Filing & Storage \* Lounge \* Breakroom \* Sit Stand \* Acoustic Tiles  
Modular Walls \* Glass Walls \* Office Carpeting \* Home Living  
And more!

### SERVICES INCLUDE:

Sales & Rentals (New & Used) \* Space Planning & Design  
Budgeting & Financing \* Project Management \* Installation &  
Logistics \* Moving & Warehousing \* Inventory Management

### WE PROUDLY SERVE:

Corporate \* Residential \* Government/GSA \* Healthcare \* Education



WE SERVE ALL AGENCIES, ALL ACROSS AMERICA



**Honeywell**



**SIEMENS**



REFERENCES AVAILABLE UPON REQUEST



see more at [cubicles.com/reviews](https://cubicles.com/reviews)